



# GLASS DOORS

FOR REFRIGERATED MULTIDECKS

PARTS FOR  
YOUR PRODUCTS

[www.gtbgroup.cz](http://www.gtbgroup.cz)

## SYSTEM BENEFITS

- Energy saving up to 60-70%
- Possibility of LED lighting
- Modern design (frameless system, the print width is 12 mm only)
- More efficient product presentation thanks to the narrow frame (print)
- New frame technology
- Longer shelf life of products through constant temperature on all shelves
- Easy installation
- The system is adapted for installation in existing racks (retrofit)
- The modularity of system (possibility to combine different sizes of doors)
- Self-closing system

## SYSTEM CHARACTERISTICS

### NEW FRAME TECHNOLOGY

- The frame is made from a special material which is used in the aircraft production
- High strength
- High stability
- Low thermal transmittance
- Higher headroom of doors (glass) due to the thickness of supporting frame (4 mm only)
- Thanks to the low heat conductivity there are no heating cables required for the prevention of fogging (condensation) - "Zero Energy"

### NEW DOORS TECHNOLOGY

- Standard glass thickness is 24 mm with  $U_g = 1,1$   
Option 1:  $U_g = 0,7$   
Option 2:  $U_g = 0,57$   
(best insulation coefficient in the world for this type of doors)
- The width of printing is max. 12mm (warm spacer)  
The possibility of a transparent spacer (higher transparency without a printed frame)
- The use of magnetic seal (system similar to domestic or industrial refrigerators)
- Visible or invisible hinges

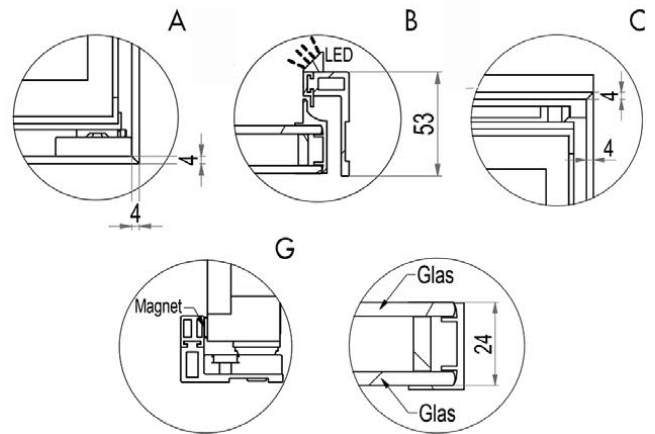
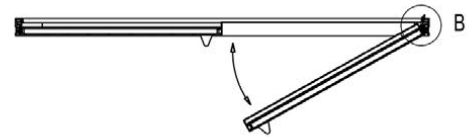
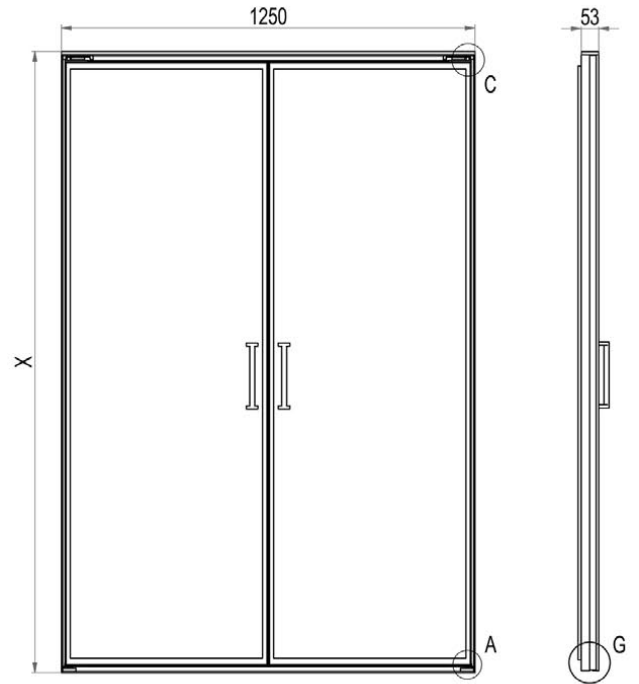

## HINGE DOORS

Option: Transparent spacer





## SYSTEM BENEFITS

- Energy saving up to 50%
- Modern design
- Possibility of LED lighting
- Automatic closing by gravity
- Comfortable and quiet gradual self-closing of doors
- Durable stops
- Longer shelf life of products through constant temperature on all shelves
- Possibility to lock open doors provides the easy access to products
- The system is adapted for installation in existing racks (retrofit)
- Easy cleaning
- Easy installation

## SYSTEM CHARACTERISTICS

- Suspension construction
- Automatic closing by gravity
- Possibility of LED lighting
- More efficient product presentation thanks to the narrow frame
- Replaceable seals

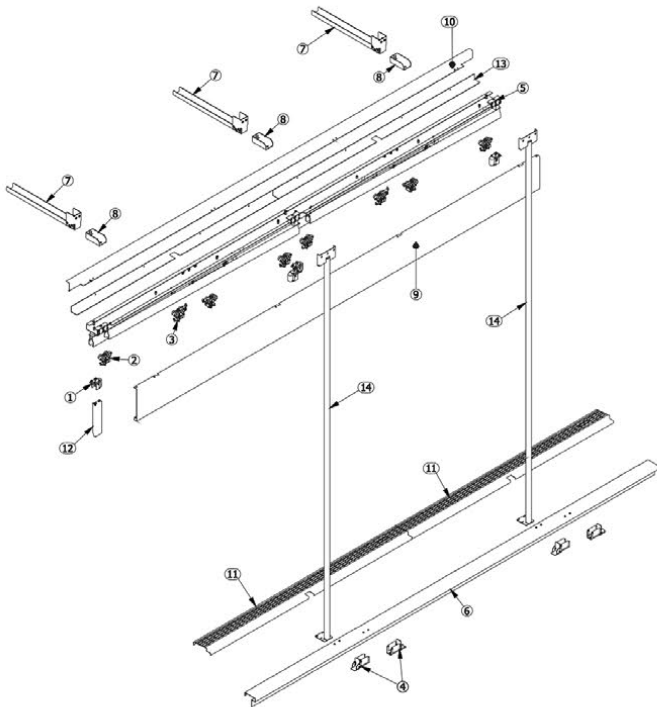

Detail of the lock



Detail of the integrated handle



Sliding doors with non-integrated handle



Sliding doors with integrated handle

# SLIDING DOORS

# GTB

[www.gtbgroupp.cz](http://www.gtbgroupp.cz)

# SLIDING & HINGE DOORS

Retrofit project and an exclusive offer in this case does not involve purchase of any new equipment, but the possibility of regeneration of older refrigerated display cases, especially wall refrigerated display cases which significantly contribute to the overall electricity consumption of a shop. In many cases it is not necessary to immediately change the refrigeration equipment, but it is advisable to consider regeneration of the existing one as its technical condition may not be so bad. Regeneration can extend its service life by another „X“ years. Naturally, it is always important to consider the possibilities and condition in individual stores, their sales and locations, and above all, to check the condition of the display case before any potential regeneration.

## RETROFIT



Retrofit references  
(MAKRO/METRO)



**GTB**  
group

GTB GROUP, s.r.o.

Na Baštici 350, 738 01 Staré Město, Frýdek-Místek, Czech republic

tel.: +420 558 442 320, +420 558 442 394, fax: +420 558 442 399, e-mail: export@gtb.cz

PARTS FOR  
YOUR PRODUCTS

[www.gtbgroupp.cz](http://www.gtbgroupp.cz)